

WGS 84 POSITIONS can be plotted directly on this chart

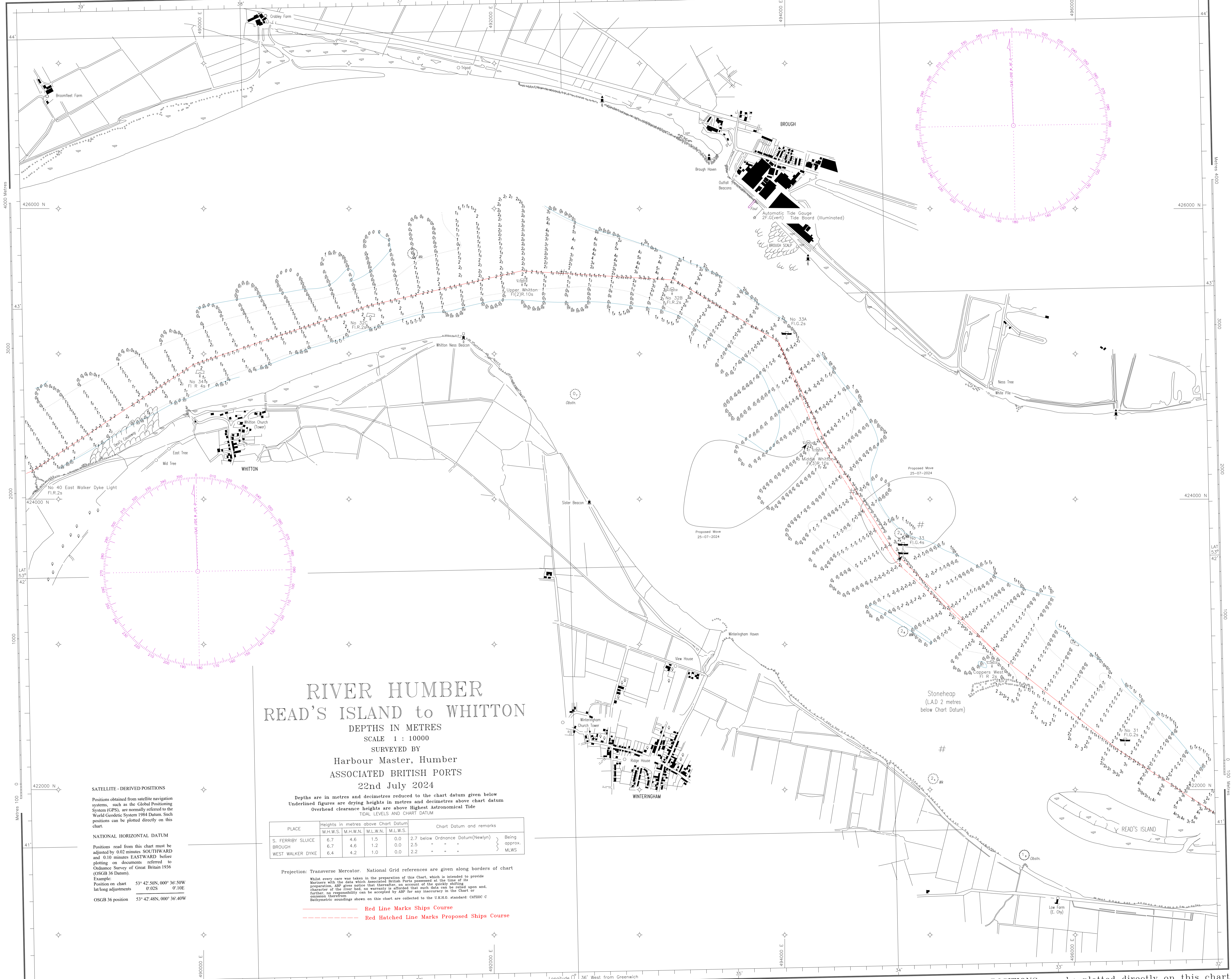

RIVER HUMBER
READ'S ISLAND to WHITTON
 DEPTHS IN METRES
 SCALE 1 : 10000
 SURVEYED BY
 Harbour Master, Humber
 ASSOCIATED BRITISH PORTS
 22nd July 2024

Depths are in metres and decimetres reduced to the chart datum given below
 Underlined figures are drying heights in metres and decimetres above chart datum
 Overhead clearance heights are above Highest Astronomical Tide
 TIDAL LEVELS AND CHART DATUM

PLACE	Heights in metres above Chart Datum				Chart Datum and remarks
	M.H.W.S.	M.H.W.N.	M.L.W.N.	M.L.W.S.	
S. FERRIBY SLUCE	6.7	4.6	1.5	0.0	2.7 below Ordnance Datum(Newlyn)
BROUGH	6.7	4.6	1.2	0.0	2.5 " " "
WEST WALKER DYKE	6.4	4.2	1.0	0.0	2.2 " " "

Projection: Transverse Mercator. National Grid references are given along borders of chart
 Whilst every care was taken in the preparation of this Chart, which is intended to provide
 Mariners with the data which Associated British Ports possessed at the time of its
 preparation, ABP gives notice that thereafter, on account of the quality shifting
 character of the river bed, no warranty is afforded that such data can be relied upon and,
 further, no responsibility can be accepted by ABP for any inaccuracy in the Chart or
 omission therefrom.
 Bathymetric soundings shown on this chart are collected to the U.K.H.O. standard: CATZOC C

Red Line Marks Ships Course
 Red Hatched Line Marks Proposed Ships Course

SATELLITE - DERIVED POSITIONS
 Positions obtained from satellite navigation systems, such as the Global Positioning System (GPS), are normally referred to the World Geodetic System 1984 Datum. Such positions can be plotted directly on this chart.
NATIONAL HORIZONTAL DATUM
 Positions read from this chart must be adjusted by 0.02 minutes SOUTHWARD and 0.10 minutes EASTWARD before plotting on documents referred to Ordnance Survey of Great Britain 1936 (OSGB 36 Datum).
 Example:
 Position on chart 53° 42' 30N, 000° 36' 50W
 lat/long adjustments 0' 02S 0' 10E
 OSGB 36 position 53° 42' 48N, 000° 36' 40W